

# Chinon Auto GX

Motorized - Focus Free

35mm compact camera

(This manual can be used for many typical "point and shoot" cameras)

This is the full text and images from the manual.

This camera manual library is for reference and historical purposes, all rights reserved.

This page is copyright© by [mike@butkus.org](mailto:mike@butkus.org) M. Butkus, N.J.  
This page may not be sold or distributed without the expressed permission of the producer  
I have no connection with Chinon Co., Japan

**If you find this manual useful, how about a donation of \$3 to:**

**M. Butkus, 29 Lake Ave., High Bridge, NJ 08829**

**and send your e-mail address so I can thank you.**

**Most other places would charge you \$7.50 for a electronic copy  
or \$18.00 for a hard to read Xerox copy.**

**This will allow me to continue to buy new manuals and pay their shipping costs.**

**It'll make you feel better, won't it?**

If you use Pay Pal, use the link below. Use the above address for a check, M.O. or cash.

Venmo is @mike-butkus-camera



[www.PayPal.me/butkus](http://www.PayPal.me/butkus)

[Back to main Chinon/Ricoh manuals page](#)

[Problems opening PDF files or printing problems - click here](#)

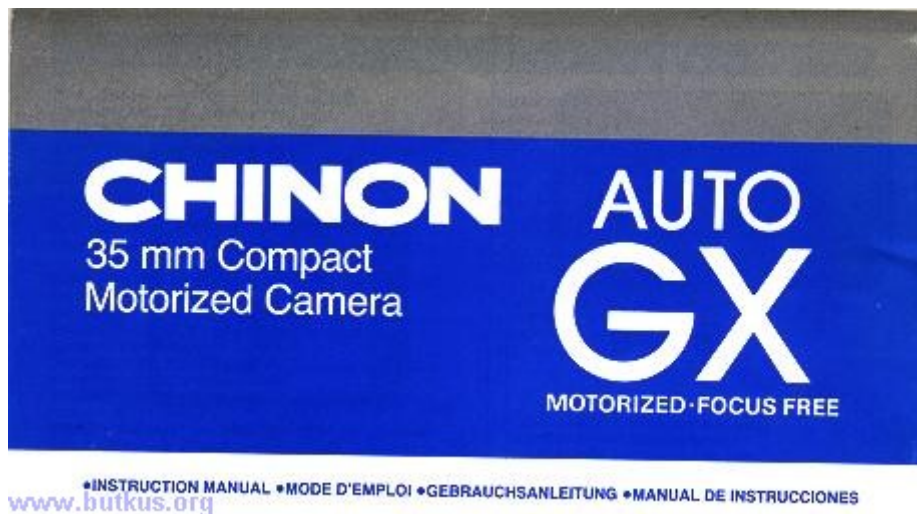

**TYPE:** Lens shutter type automatic 35 mm compact camera.

**PICTURE FORMAT:** 24x36 mm

**LENS:** 35 mm f4.5, 3 elements in 3 groups

**VIEWFINDER:** Inversed Galilean viewfinder, under exposure warning/Battery check LED.

**SHUTTER:** Mechanically, controlled shutter, Shutter speed 1/125 sec., Shutter locks when the lens cover is closed.

**EXPOSURE METER:** Controlled by three aperture settings of F4.5, 8, 16 CdS photo cell for under exposure warning.

**ISO RANGE:** Two position settings of ISO 100/200 and ISO 400/1000

**FOCUSING:** Fixed type, 1.3 meter (4.26 ft) to infinity.

**FILM LOADING:** Auto loading system by built-in motor.

**FILM WIND:** Automatic power winder for single frame advance.

**FILM REWIND:** Automatic power rewinding, rewind actuated with rewind switch.

**AUTO REWIND STOP:** Film rewinding automatically stops upon completion.

**EXPOSURE COUNTER:** Indicates number of exposed and returns frame by frame while rewinding, and resets to "S" when camera back is opened. www.chinabooks.org

**FLASH:** Built-in fixed flash unit. Guide number 10 (ISO 100: meter), Effective range of 1.6-3.1 meter (5.25-10.17 ft) at ISO 100. Recycling time of approximately 5 seconds. Flash ready indicator built-in.

**LENS COVER:** Built-in, shutter locks with lens cover closed.

**OTHER FEATURES:** Film type window and hand strap.

**POWER SOURCE:** Two 1.5 V "AA" size alkaline batteries. —

**DIMENSIONS:** 129(W)x70(H)x45(D) mm (5.08x2.76 X 1.7T")

**WEIGHT:** 250 grams (8.83 oz)

[Wording between these brackets are mine alone]

## NOMENCLATURE

1. Hand strap	5. Flash switch
2. Shutter release button	6. Film speed setting lever
3. Viewfinder	7. Film speed scale
4. Flash	8. Lens cover
	9. Lens

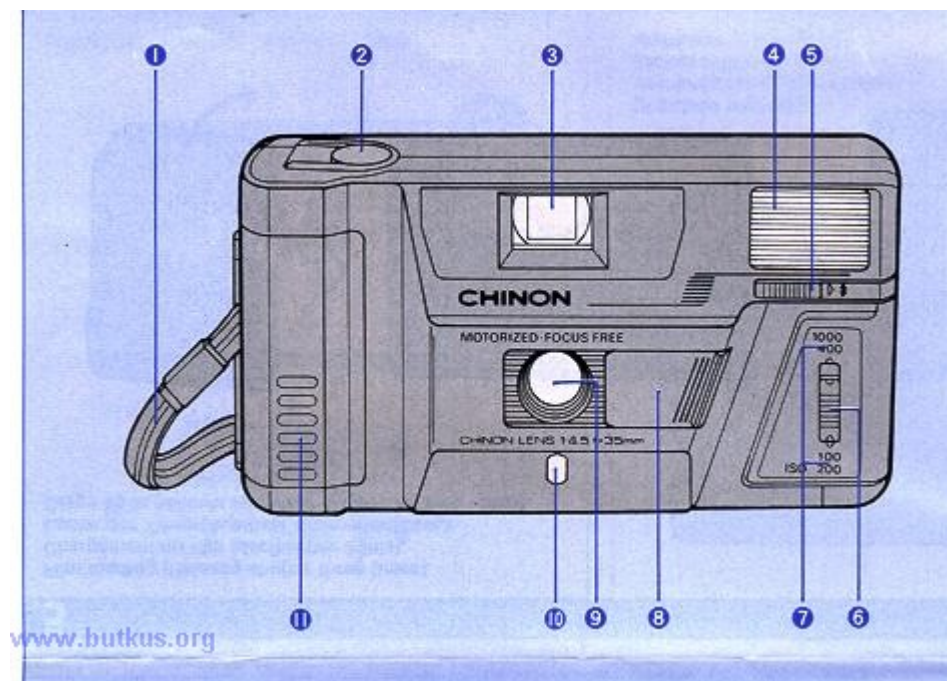

- 10. Exposure metering window
- 11. Grip
- 12. Back cover release button
- 13. Frame counter

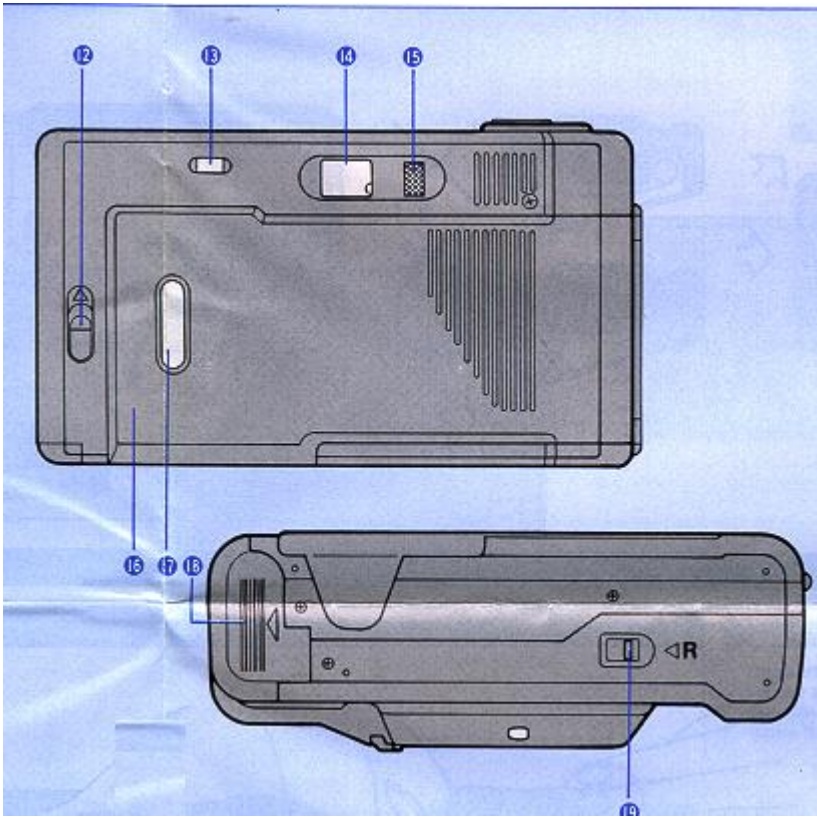

14. Viewfinder eyepiece

15. Flash ready indicator

16. Back cover

17. Cartridge window

18. Battery compartment cover

19. Rewind switch

20. Rewind shaft

21. Sprocket

22. Take-up spool

23. Film pressure plate

24. Film tip mark

25. Film guide

26. Film chamber

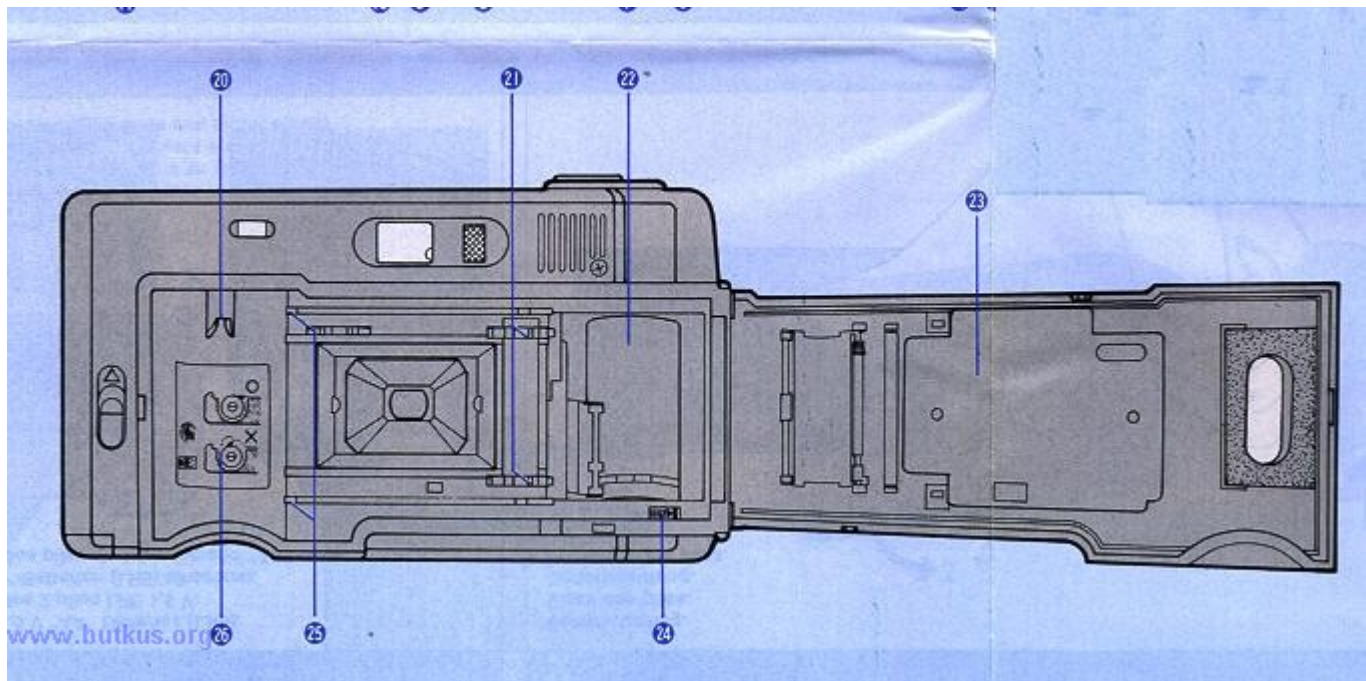

20. Film

[Below are the images from the fold-out users manual.]

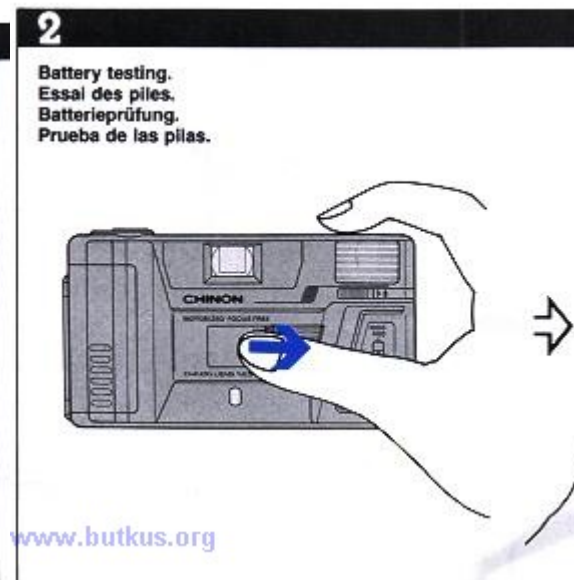
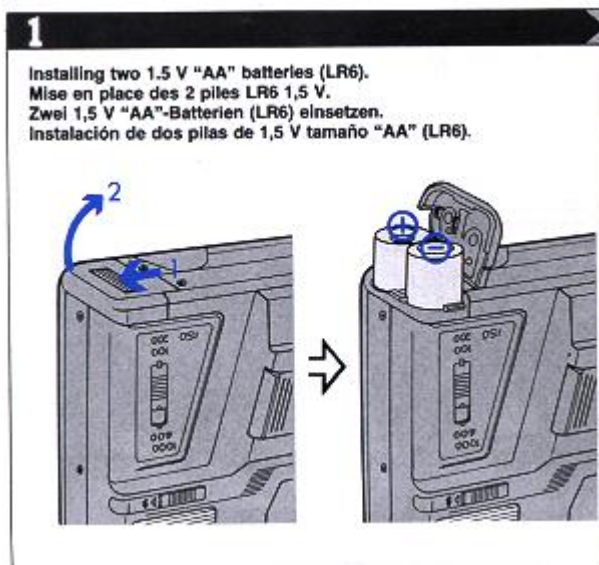

[www.butkus.org](http://www.butkus.org)



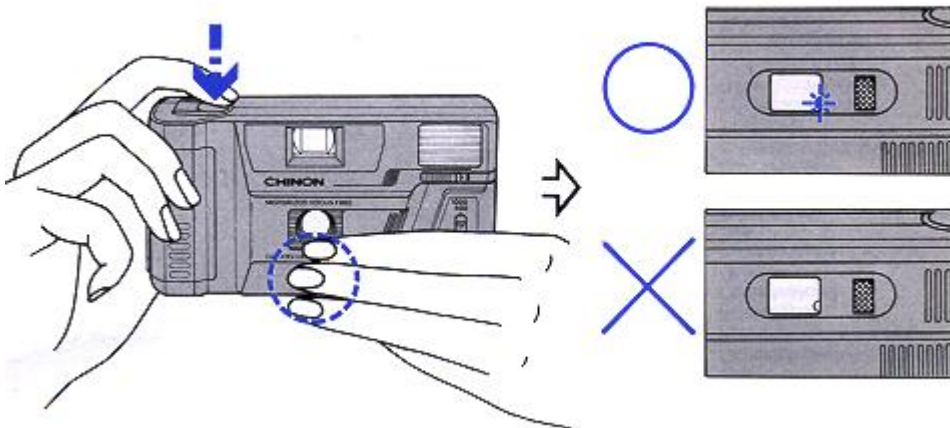

[What you are doing here is covering up the "electric eye" of the camera and gently pressing the shutter. If the batteries are good, the electric eye will see complete darkness and show in the viewfinder the flash is needed.].....

**3**

Film speed setting (for color negatives).  
 Réglage de la sensibilité du film (négatifs couleur).  
 Einstellung der Filmempfindlichkeit (für Farbnegativfilm).  
 Ajuste de la sensibilidad de la película (para negativos en color).

**4**

Focus range.  
 Plage de mise au point.  
 Scharfeinstellbereich.  
 Alcance de enfoque.

[This camera does not have "Auto DX" where it can determine the film speed automatically.]

5

Film loading (Release shutter three times).  
Chargement du film (déclencher 3 fois).  
Laden des Films (Auslöser dreimal drücken).  
Carga de la película (active el disparador tres veces).

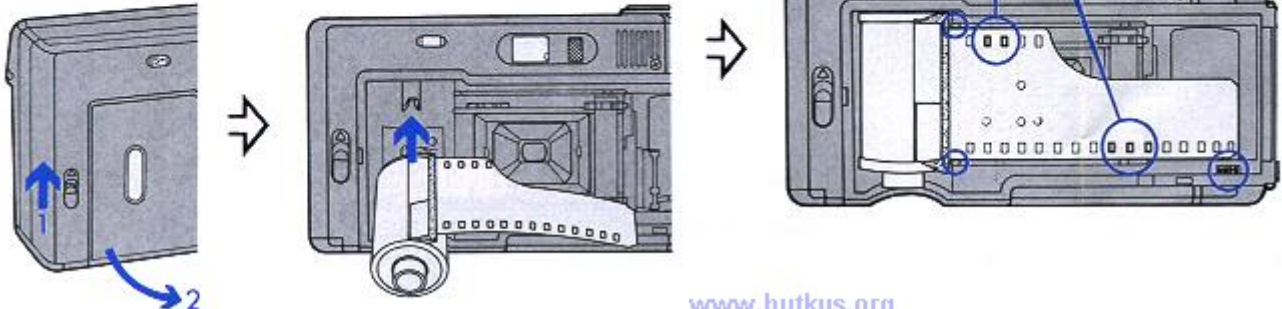

[www.butkus.org](http://www.butkus.org)

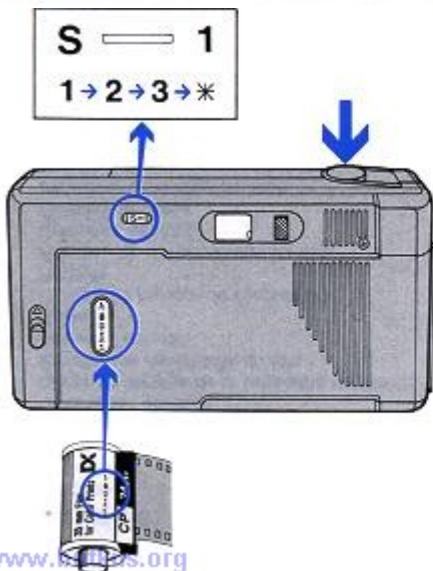
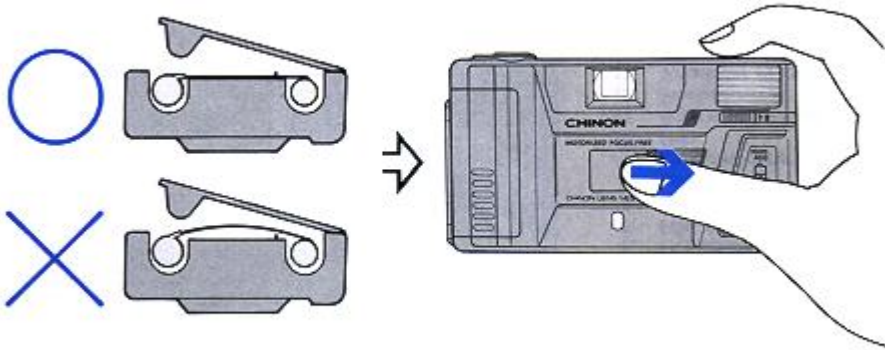

[www.butkus.org](http://www.butkus.org)

Maintien de l'appareil.  
Halten der Kamera.  
Sujeción de la cámara.

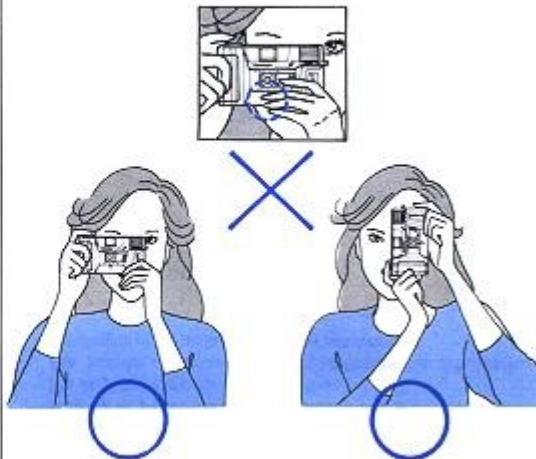

[Make sure the numbers advance when you are shooting pictures. If not, the film is not loaded correctly. Hold the camera with your hands away from the lens and electric eye.]

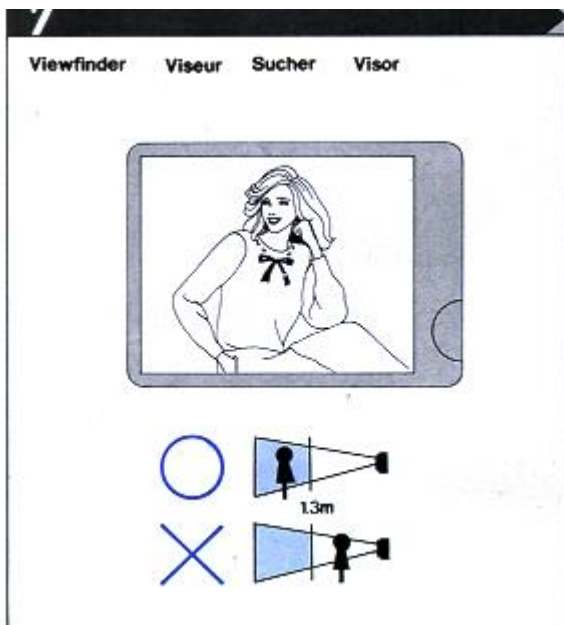

[Do not take photos closer then 3 1/2 feet.]

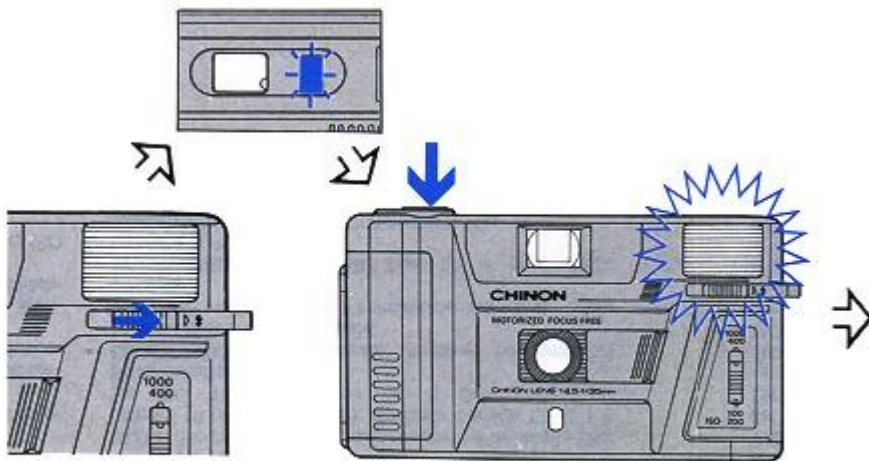

[www.butkus.org](http://www.butkus.org)

[When needing the flash, pull out the flash "on" lever. The flash "ready" light must glow before you fire. If the flash takes more then 30 seconds to charge, your batteries are getting very week.]



## 10

Flash photography range (for color negatives).  
 Plage de prise de vue au flash (pour négatifs couleur).  
 Blitzbereich (für Farbnegativfilm).  
 Alcance de la fotografía con flash (para negativos en color).

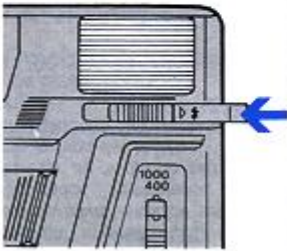

ISO 100/21°	1.6–3.1 m	5.3–10 ft.
ISO 200/24°	1.6–4.4 m	5.3–14 ft.
ISO 400/27°	1.3–3.5 m	4.3–11 ft.
ISO 1000/31°	1.3–5.6 m	4.3–18 ft.

[This is a guide to the max distance you can use the flash.]

## 11

Automatic rewinding (Film ends and motor stops).  
 Rebobinage automatique (le moteur s'arrête en fin de film).  
 Automatische Rückspulung (Film zu Ende, Motor stoppt).  
 Rebobinado automático (al finalizar la película se para el motor).

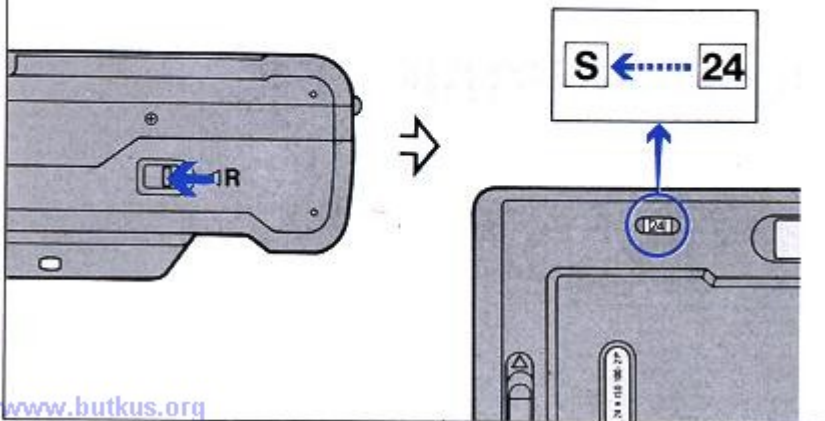

[After you fire and the motor will not advance, press the rewind button on the bottom. Make sure your batteries are not just weak, check your exposure number through the back window against the number of frames fired. The batteries could be so weak that they don't advance the film. Just change batteries, don't open the back.]

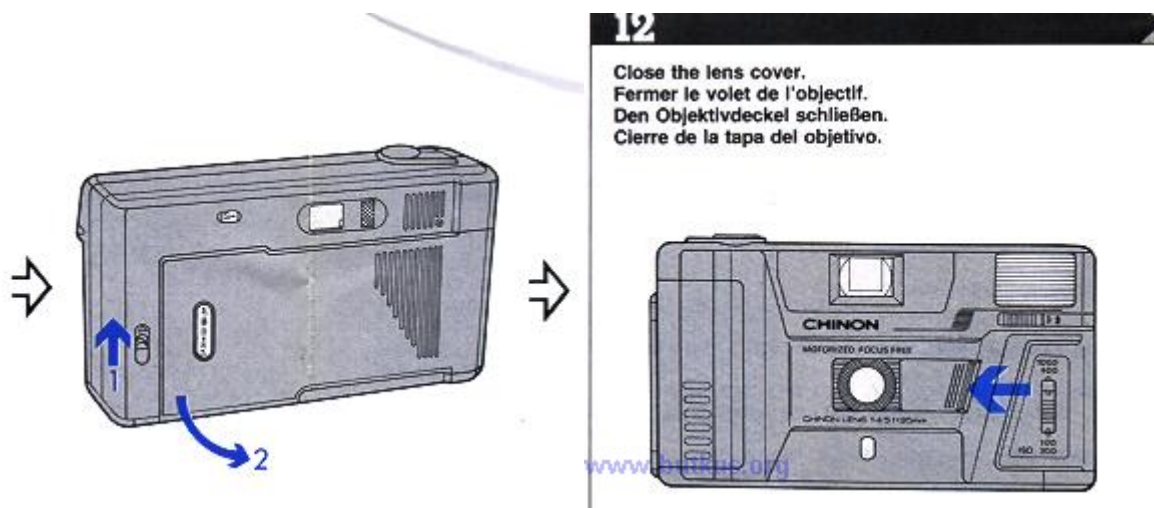

[When completely rewound, open the back. When not in use, close the lens cover. Again should the film not completely rewind (you should hear the motor whine slowly until the film comes off the spool, then wind fast for a second or two) or the film number window not go to S, change batteries without opening the back.]

#### NOTE:

1. Do not use Ni-Cad batteries, use alkaline batteries
2. If you do use the camera for a long periods if time, remove the batteries, and store in a dry location.
3. Underexposure may result if the shutter is released before the flash-ready light illuminates.
4. The shutter will be locked when the lens comer is in the closed position.